

# APPENDIX (10)

## **Town and Country Planning (Tree Preservation) (England) Regulations 2012**

Town and Country Planning Act 1990

Tree Preservation Order (13) 2016

Bromsgrove District Council in exercise of the powers conferred on them by section 198 of the Town and Country Planning Act 1990 make the following Order—

### **Citation**

1. This Order may be cited as Tree Preservation order (13) 2016

### **Interpretation**

- 2.— (1) In this Order “the authority” means Bromsgrove District Council.

(2) In this Order any reference to a numbered section is a reference to the section so numbered in the Town and Country Planning Act 1990 and any reference to a numbered regulation is a reference to the regulation so numbered in the Town and Country Planning (Tree Preservation)(England) Regulations 2012.

### **Effect**

3.— (1) Subject to article 4, this Order takes effect provisionally on the date on which it is made.

(2) Without prejudice to subsection (7) of section 198 (power to make tree preservation orders) or subsection (1) of section 200 (tree preservation orders: Forestry Commissioners) and, subject to the exceptions in regulation 14, no person shall—

- (a) cut down, top, lop, uproot, wilfully damage, or wilfully destroy; or
- (b) cause or permit the cutting down, topping, lopping, uprooting, wilful damage or wilful destruction of,

any tree specified in the Schedule to this Order except with the written consent of the authority in accordance with regulations 16 and 17, or of the Secretary of State in accordance with regulation 23, and, where such consent is given subject to conditions, in accordance with those conditions.

### **Application to trees to be planted pursuant to a condition**

4. In relation to any tree identified in the first column of the Schedule by the letter “C”, being a tree to be planted pursuant to a condition imposed under paragraph (a) of section 197 (planning permission to include appropriate provision for preservation and planting of trees), this Order takes effect as from the time when the tree is planted.

Dated this 3<sup>rd</sup> August 2016

Signed on behalf of Bromsgrove District Council



**Clare Flanagan**  
**Principal Solicitor**

Authorised by the Council to sign in that behalf

**SCHEDULE**

**Specification of trees**

**Trees specified individually**

(encircled in black on the map)

**NONE**

**Trees specified by reference to an area**

(within a dotted black line on the map)

**NONE**

**Groups of Trees**

(within a broken black line on the map)

**NONE**

**Woodlands**

(within a continuous black line on the map)

| <u>No. on Map</u> | <u>Description</u>                                       | <u>NGR</u>     | <u>Situation</u>   |
|-------------------|--|----------------|--|
| W1                | All trees of any size and species within W1 on the plan. | 399725, 272531 | Land at side and rear of 73 Linthurst Newtown, Blackwell |

# Tree Preservation Order (13) 2016

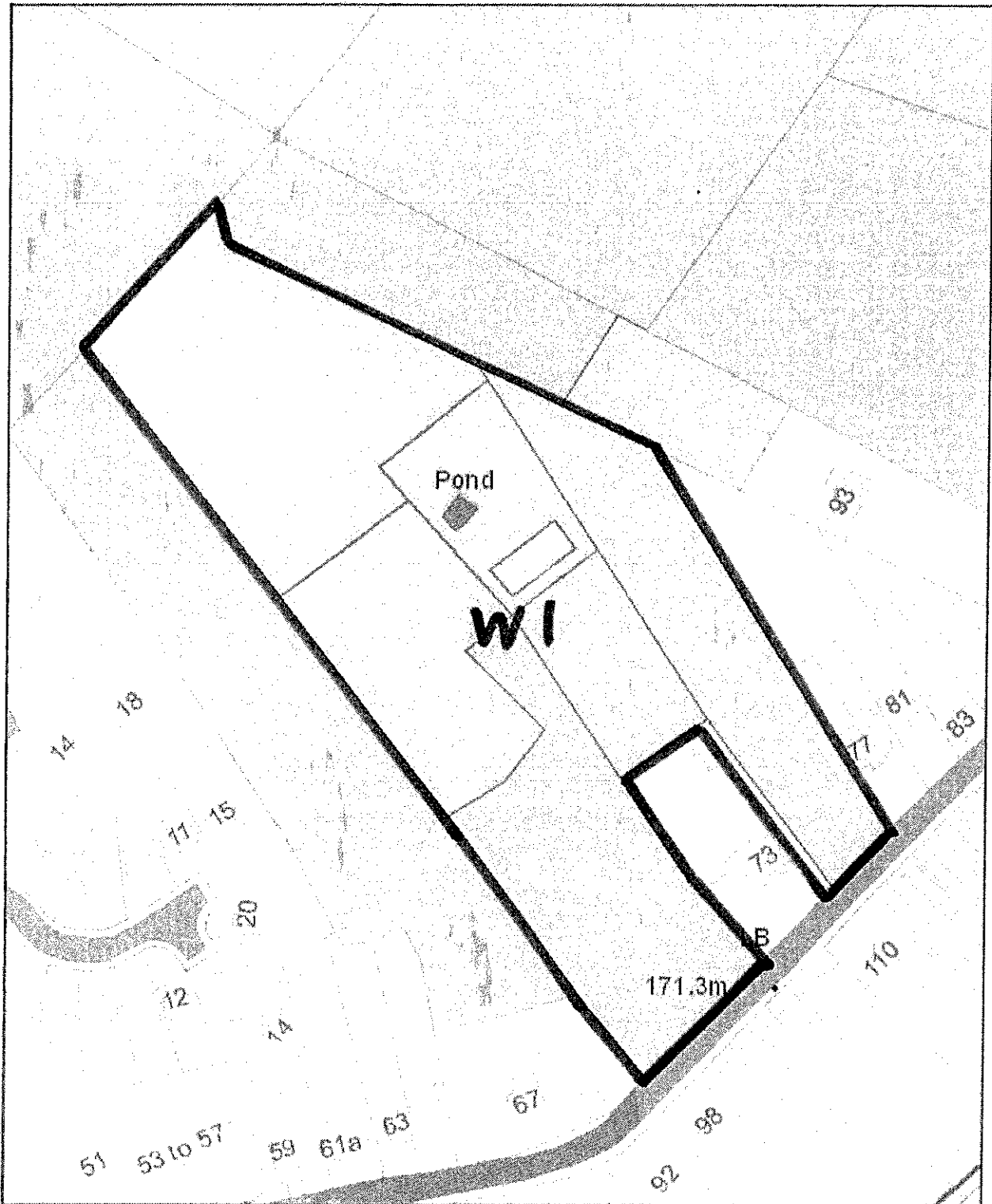

Scale 1:1250

This product includes mapping data licensed from Supplier with permission, OS Licence Number 100023519 (2011).  
NOTES



DATE TIME

BROMSGROVElla.buckfitch

*CLARE FLANAGAN*

3 AUGUST 2016